

P:\01.Engineering\Chino_City of\16305 - Benson Reservoir and Improvements (W213) Design and Bid Support\6-CAD\Exhibits\PR Exhibit PLOTTED: 7/8/2025 11:21:48 AM

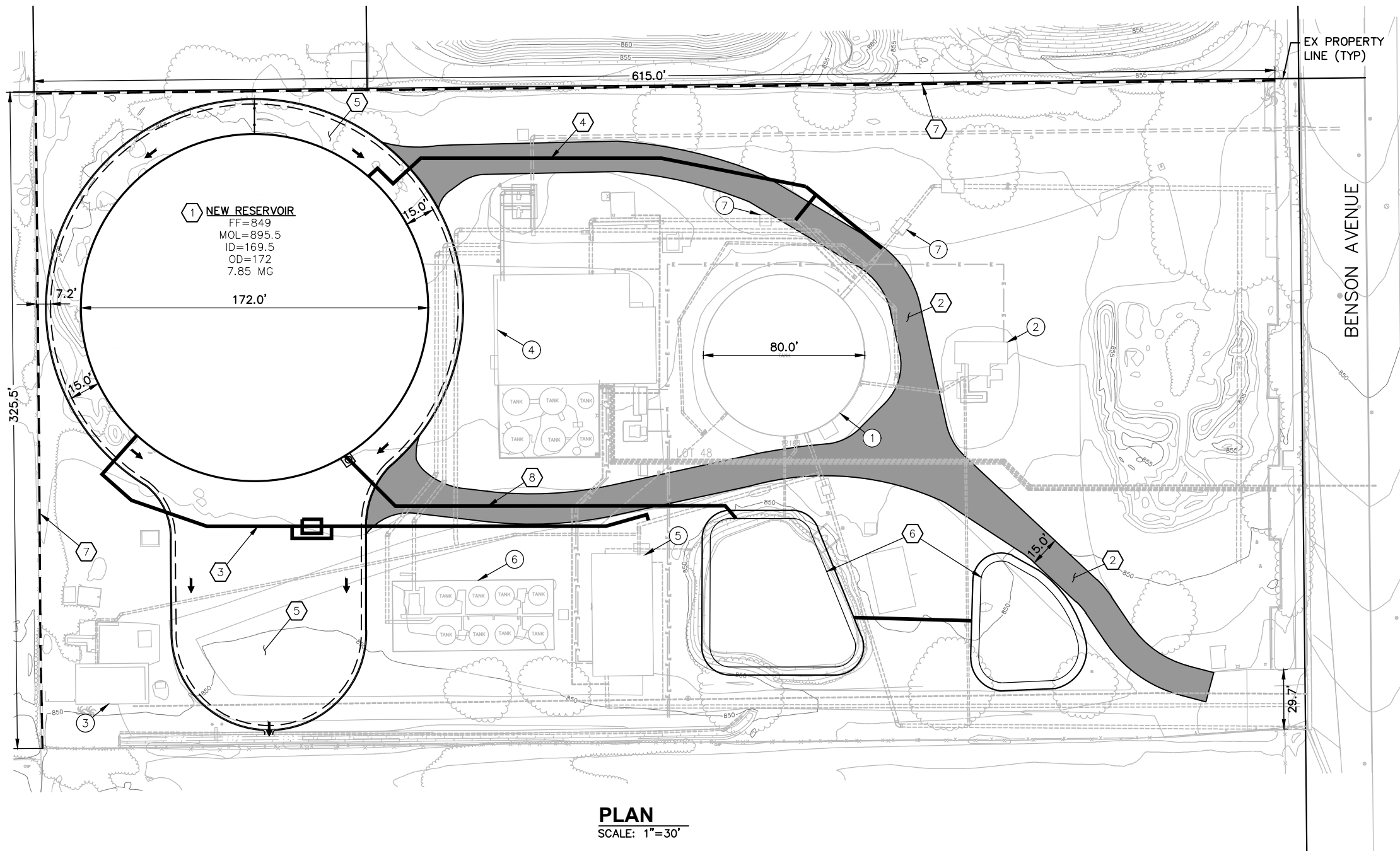

PLAN
SCALE: 1"=30'

EXISTING SITE FEATURES

- ① EX 1.5 MG BENSON RESERVOIR #3
- ② EX WELL #5
- ③ EX WELL #9
- ④ ION EXCHANGE FACILITY
- ⑤ BENSON BOOSTER PUMP STATION
- ⑥ GAC TREATMENT FACILITY
- ⑦ PRESSURE REDUCING VALVE

CONSTRUCTION NOTES

- ① NEW 7.85 MG BENSON RESERVOIR #3
- ② NEW 15' WIDE CLASS II BASE ROAD
- ③ NEW 20" OUTLET PIPING
- ④ NEW 24" INLET PIPING
- ⑤ NEW CLASS II BASE PERIMETER ROAD AND TURN AROUND WITH CONCRETE CURB AND GUTTER
- ⑥ NEW RETENTION BASIN
- ⑦ REPLACE EX FENCING WITH NEW 8-FOOT CMU WALL WITH THREE STRING BARBED WIRE
- ⑧ NEW 24" HDPE OVERFLOW DRAIN

LEGEND

- NEW PIPELINE ALIGNMENT
- CURB AND GUTTER / ROLLED CURB
- DG PAVEMENT ROAD LIMIT

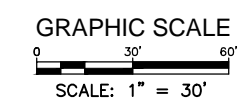

LINE IS 2 INCHES
AT FULL SIZE
IF NOT 2" - SCALE ACCORDINGLY

DUDEK
605 THIRD STREET
ENCINITAS, CA 92024
760.942.5147

**BENSON AVENUE RESERVOIR
IMPROVEMENTS PROJECT**
APPENDIX B - 30% SITE PLAN

FOR CITY OF CHINO

EXHIBIT

16305



New Benson Reservoir

Existing Benson Reservoir to be Removed