

PROPOSED BOUNDARY MAP
COMMUNITY FACILITIES DISTRICT NO. 2026-1 (THE MEADOWS)
CITY OF CHINO
SAN BERNARDINO COUNTY, STATE OF CALIFORNIA

I HEREBY CERTIFY THAT THE WITHIN MAP SHOWING THE PROPOSED BOUNDARY OF COMMUNITY FACILITIES DISTRICT NO. 2026-1 OF THE CITY OF CHINO, SAN BERNARDINO COUNTY, STATE OF CALIFORNIA, WAS APPROVED BY THE CITY COUNCIL OF THE CITY OF CHINO AT A REGULAR MEETING THEREOF, HELD ON THE ____ DAY OF _____, 20____, BY IT'S RESOLUTION NO. _____.

CITY CLERK, CITY OF CHINO

FILED IN THE OFFICE OF THE CITY CLERK OF THE CITY OF CHINO THIS ____ DAY OF _____, 20____.

BY: _____
CITY CLERK, CITY OF CHINO

SAN BERNARDINO COUNTY RECORDER'S CERTIFICATE

THIS MAP HAS BEEN FILED UNDER DOCUMENT NUMBER _____ THIS ____ DAY OF _____, 20____, AT ____ M., IN BOOK ____ OF _____ AT PAGE _____, AT THE REQUEST OF CITY OF CHINO IN THE AMOUNT OF \$ _____.

JOSIE GONZALES
ASSESSOR-RECORDER-COUNTY CLERK
SAN BERNARDINO COUNTY

BY: _____
DEPUTY RECORDER

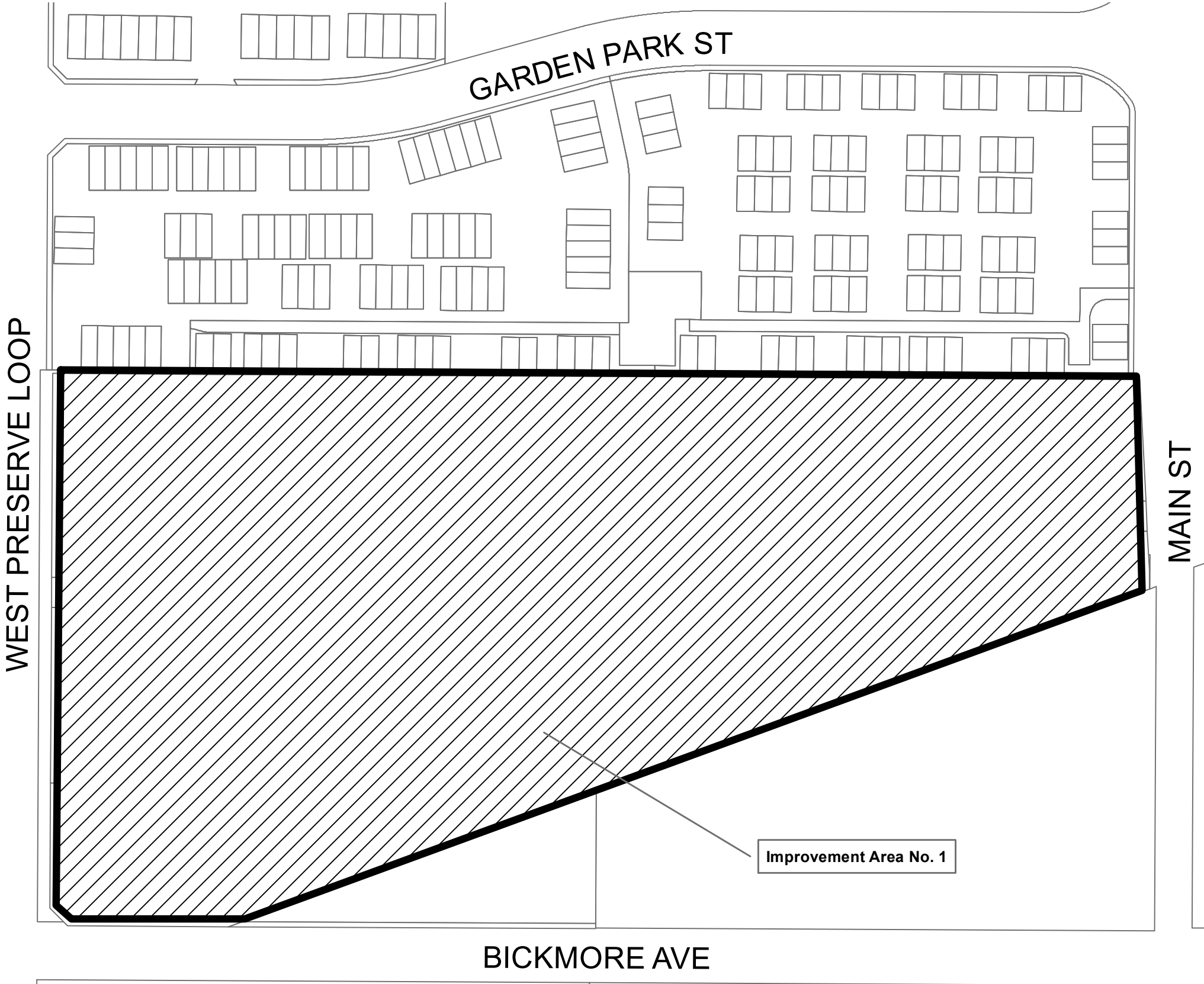
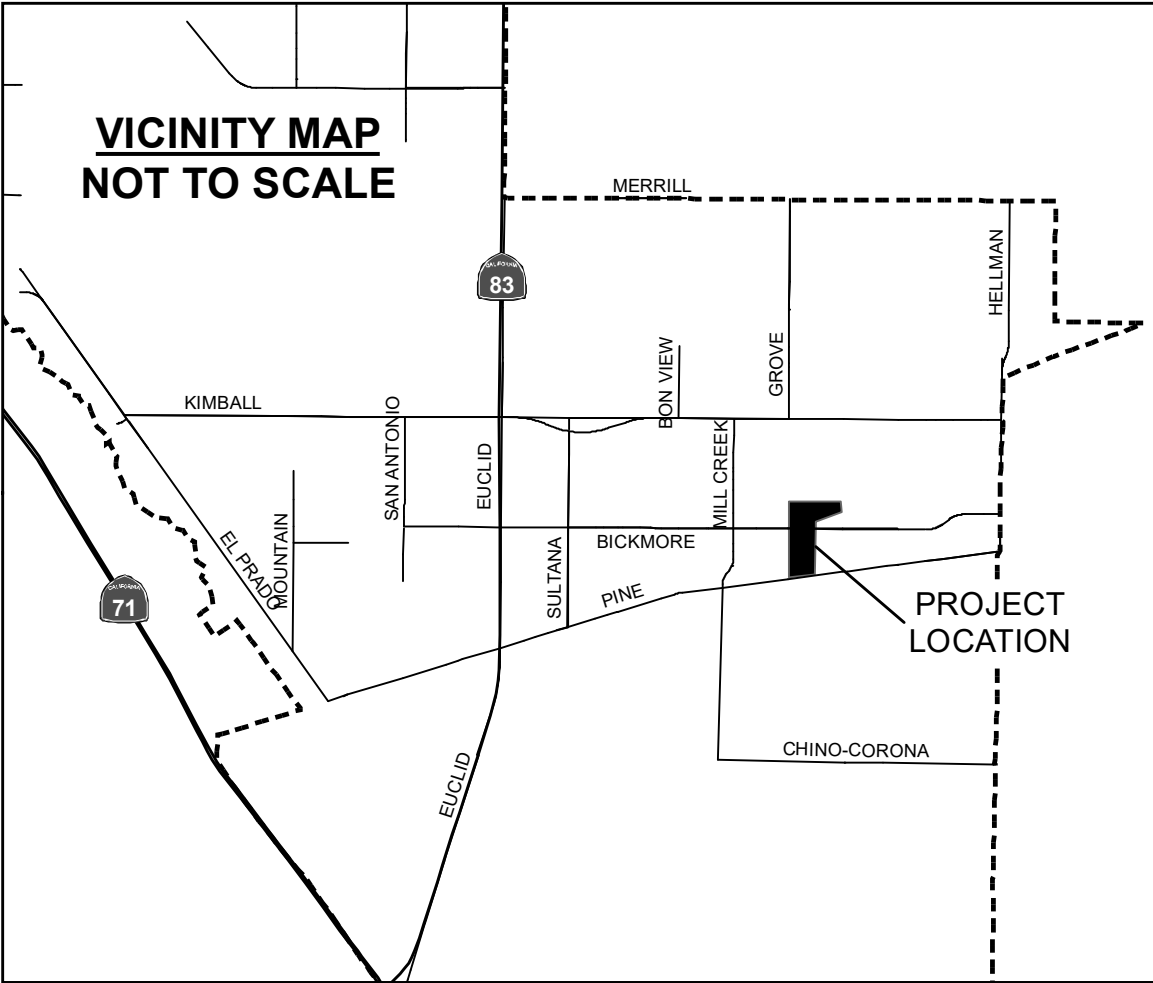

IMPROVEMENT AREA No. 1
COMPRISED OF PARCEL 1055-461-07-0000 (PORTION). FOR DETAILS CONCERNING THE LINES AND DIMENSIONS OF IMPROVEMENT AREA NO. 1, REFER TO LOT 1 OF TRACT MAP NO. 20312-2, FILED IN BOOK 370, PAGES 24 THROUGH 30, INCLUSIVE OF MAPS, IN THE OFFICE OF THE COUNTY RECORDER OF SAN BERNARDINO COUNTY.

PARCEL NUMBERS
1055-461-07-0000
1057-121-01-0000
1057-131-02-0000

LEGEND

	PROPOSED BOUNDARY	
	PARCEL BOUNDARY	
XXXX-XXX-XX-XXXX	PARCEL NUMBER	

IMPROVEMENT AREA NO. 1
IMPROVEMENT AREA NO. 2
IMPROVEMENT AREA NO. 3

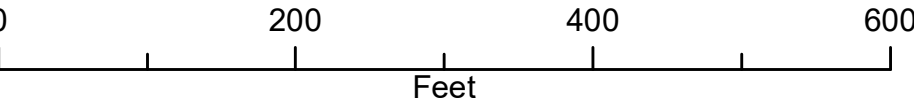

THIS MAP CORRECTLY SHOWS THE LOT OR PARCEL OF LAND INCLUDED WITHIN THE BOUNDARIES OF THE COMMUNITY FACILITIES DISTRICT. FOR DETAILS CONCERNING THE LINES AND DIMENSIONS OF LOTS OR PARCELS REFER TO THE SAN BERNADINO COUNTY ASSESSOR'S MAPS FOR FISCAL YEAR 2025-2026.

PROPOSED BOUNDARY MAP
COMMUNITY FACILITIES DISTRICT NO. 2026-1 (THE MEADOWS)
CITY OF CHINO
SAN BERNARDINO COUNTY, STATE OF CALIFORNIA

IMPROVEMENT AREA NO. 2 DESCRIPTION:

THOSE PORTIONS OF LOTS 4 AND G OF TRACT MAP NO. 20312-2, AS PER MAP FILED IN BOOK 370, PAGES 24 THROUGH 30, INCLUSIVE OF MAPS, IN THE OFFICE OF THE COUNTY RECORDER OF SAID COUNTY, DESCRIBED AS FOLLOWS:

PARCEL 1:

BEGINNING AT THE SOUTHEAST CORNER OF LOT 4 OF TRACT MAP NO. 20312-2, AS PER MAP FILED IN BOOK 370, PAGES 24 THROUGH 30, INCLUSIVE OF MAPS, IN THE OFFICE OF THE COUNTY RECORDER OF SAID COUNTY, THENCE, SOUTH 40° 31' 04" WEST, 11.18 FEET; THENCE, SOUTH 81° 43' 43" WEST, 313.93 FEET TO THE BEGINNING OF A TANGENT CURVE CONCAVE NORTHERLY AND HAVING A RADIUS OF 232.00 FEET; THENCE WESTERLY ALONG SAID CURVE THROUGH A CENTRAL ANGLE OF 08° 31' 51" AN ARC DISTANCE 34.54 FEET; THENCE, NORTH 89° 44' 26" WEST, 41.37 FEET TO THE BEGINNING OF A TANGENT CURVE CONCAVE SOUTHERLY AND HAVING A RADIUS OF 298.00 FEET, THENCE WESTERLY ALONG SAID CURVE THROUGH A CENTRAL ANGLE OF 08° 31' 51" AN ARC DISTANCE 44.37 FEET; THENCE, SOUTH 81° 43' 43" WEST, 132.04 FEET; THENCE, NORTH 49° 29' 06" WEST, 19.33 FEET; THENCE, NORTH 00° 41' 55" WEST, 141.14 FEET; THENCE, NORTH 89° 18' 54" EAST, 93.14 FEET TO THE BEGINNING OF A TANGENT CURVE CONCAVE NORTHERLY AND HAVING A RADIUS OF 2017.00 FEET; THENCE EASTERLY ALONG SAID CURVE THROUGH A CENTRAL ANGLE OF 07° 35' 10" AN ARC DISTANCE 267.06 FEET; THENCE NORTH 81° 43' 43" EAST, 226.62 FEET; THENCE SOUTH 00°41'36" EAST, 130.28 FEET TO THE POINT OF BEGINNING.

PARCEL 2:

BEGINNING AT THE NORTHEAST CORNER OF LOT 4 OF TRACT MAP NO. 20312-2, AS PER MAP FILED IN BOOK 370, PAGES 24 THROUGH 30, INCLUSIVE OF MAPS, IN THE OFFICE OF THE COUNTY RECORDER OF SAID COUNTY; THENCE SOUTH 00° 41' 36" EAST, 187.93 FEET; THENCE SOUTH 89° 18' 24" WEST, 41.85 FEET TO THE BEGINNING OF A TANGENT CURVE CONCAVE SOUTHERLY AND HAVING A RADIUS OF 367.00 FEET; THENCE WESTERLY ALONG SAID CURVE THROUGH A CENTRAL ANGLE OF 20° 24' 38" AN ARC DISTANCE 130.47 FEET; THENCE SOUTH 68° 53' 46" WEST, 393.99 FEET THENCE, SOUTH 89° 18' 05" WEST, 51.02 FEET; THENCE NORTH 00° 41' 55" WEST, 128.79 FEET; THENCE NORTH 68° 53' 46" EAST, 629.66 FEET TO THE POINT OF BEGINNING.

IMPROVEMENT AREA NO. 2

COMPRISED OF PARCEL 1057-121-01-0000 (PORTION), EAST OF WEST PRESERVE LOOP, AND PARCEL 1057-131-02-0000 (PORTION), NORTH OF PINE AVENUE. FOR DETAILS CONCERNING THE LINES AND DIMENSIONS OF IMPROVEMENT AREA NO. 2, REFER TO LOT 4 OF TRACT MAP NO. 20312-2, FILED IN BOOK 370, PAGES 24 THROUGH 30, INCLUSIVE OF MAPS, IN THE OFFICE OF THE COUNTY RECORDER OF SAN BERNARDINO COUNTY.

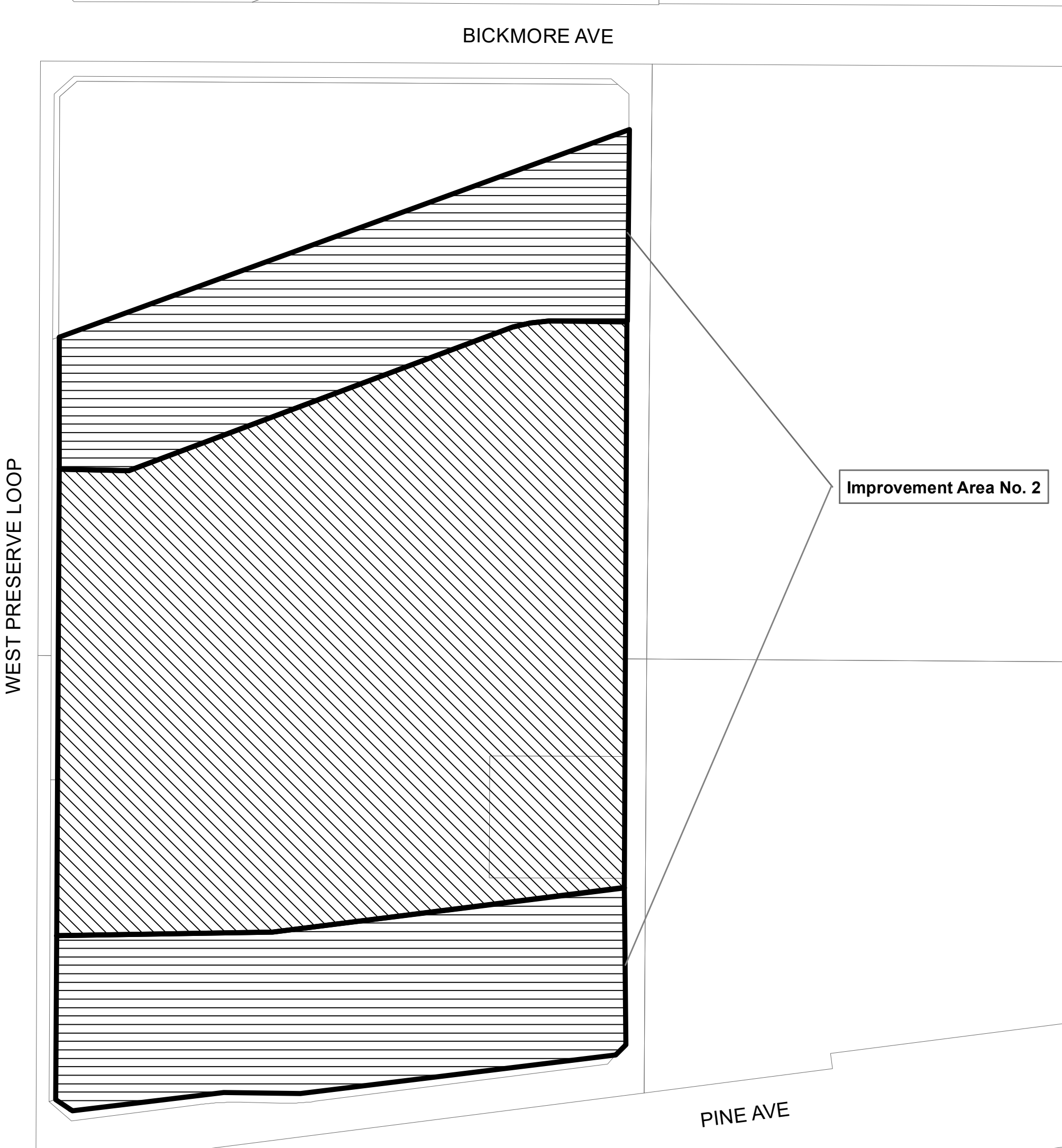

LEGEND

	PROPOSED BOUNDARY		IMPROVEMENT AREA NO. 1
	PARCEL BOUNDARY		IMPROVEMENT AREA NO. 2
	PARCEL NUMBER		IMPROVEMENT AREA NO. 3

PARCEL NUMBERS

1055-461-07-0000
1057-121-01-0000
1057-131-02-0000

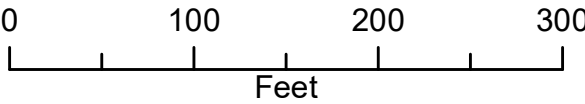

THIS MAP CORRECTLY SHOWS THE LOT OR PARCEL OF LAND INCLUDED WITHIN THE BOUNDARIES OF THE COMMUNITY FACILITIES DISTRICT. FOR DETAILS CONCERNING THE LINES AND DIMENSIONS OF LOTS OR PARCELS REFER TO THE SAN BERNADINO COUNTY ASSESSOR'S MAPS FOR FISCAL YEAR 2025-2026.

PROPOSED BOUNDARY MAP
COMMUNITY FACILITIES DISTRICT NO. 2026-1 (THE MEADOWS)
CITY OF CHINO
SAN BERNARDINO COUNTY, STATE OF CALIFORNIA

IMPROVEMENT AREA NO. 3 DESCRIPTION:

THOSE PORTIONS OF LOTS 4 AND G OF TRACT MAP NO. 20312-2, AS PER MAP FILED IN BOOK 370, PAGES 24 THROUGH 30, INCLUSIVE OF MAPS, IN THE OFFICE OF THE COUNTY RECORDER OF SAID COUNTY, DESCRIBED AS FOLLOWS:

PARCEL 1:

BEGINNING AT THE NORTHEAST CORNER OF LOT 4 OF TRACT MAP NO. 20312-2, AS PER MAP FILED IN BOOK 370, PAGES 24 THROUGH 30, INCLUSIVE OF MAPS, IN THE OFFICE OF THE COUNTY RECORDER OF SAID COUNTY; THENCE SOUTH 00° 41' 36" EAST, 187.93 FEET TO THE TRUE POINT OF BEGINNING; THENCE SOUTH 00° 41' 36" EAST, 622.50 FEET THENCE SOUTH 81° 43' 43" WEST, 226.62 FEET TO THE BEGINNING OF A TANGENT CURVE CONCAVE NORTHERLY AND HAVING A RADIUS OF 2017.00 FEET; THENCE WESTERLY ALONG SAID CURVE THROUGH A CENTRAL ANGLE OF 07° 35' 10" AN ARC DISTANCE 267.06 FEET; THENCE SOUTH 89° 18' 54" WEST, 93.14 FEET; THENCE NORTH 00° 41' 54.6" WEST, 509.54 FEET; THENCE NORTH 89° 18' 05" EAST, 45.02 FEET; THENCE NORTH 68° 53' 46" EAST, 393.99 FEET TO THE BEGINNING OF A TANGENT CURVE CONCAVE SOUTHERLY AND HAVING A RADIUS OF 367.00 FEET; THENCE EASTERLY ALONG SAID CURVE THROUGH A CENTRAL ANGLE OF 20° 24' 38" AN ARC DISTANCE 130.47 FEET; THENCE NORTH 89° 18' 24" EAST, 41.85 FEET TO THE TRUE POINT OF BEGINNING.

IMPROVEMENT AREA NO. 3

COMPRISED OF PARCEL 1057-121-01-0000 (PORTION) AND PARCEL 1057-131-02-0000 (PORTION). FOR DETAILS CONCERNING THE LINES AND DIMENSIONS OF IMPROVEMENT AREA 3, REFER TO LOTS 4 AND 5 OF TRACT MAP No. 20312-2, FILED IN BOOK 370, PAGES 24 THROUGH 30, INCLUSIVE OF MAPS, IN THE OFFICE OF THE COUNTY RECORDER OF SAN BERNARDINO COUNTY.

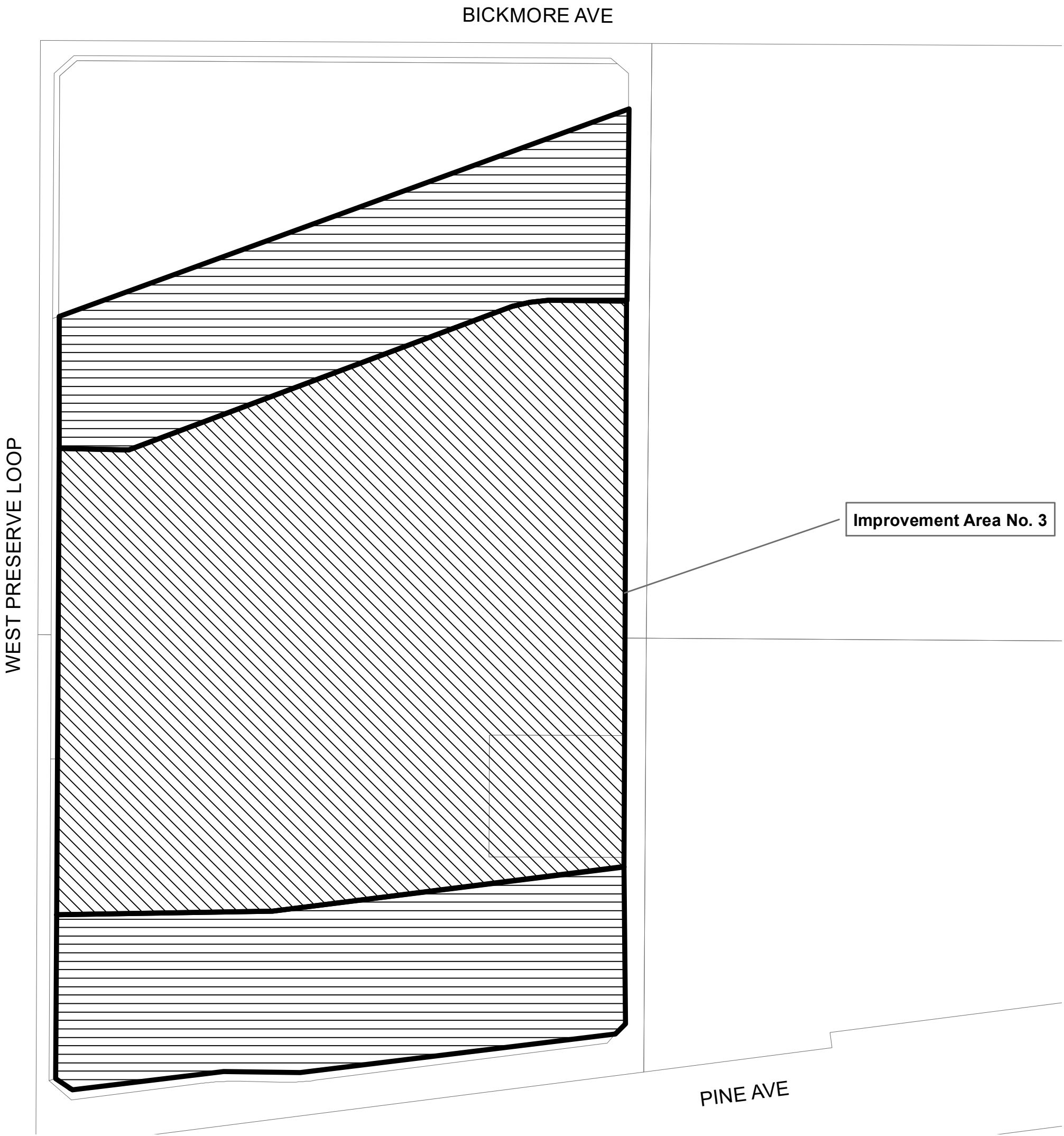

LEGEND

	PROPOSED BOUNDARY		IMPROVEMENT AREA NO. 1
	PARCEL BOUNDARY		IMPROVEMENT AREA NO. 2
XXXX-XXX-XX-XXXX	PARCEL NUMBER		IMPROVEMENT AREA NO. 3

PARCEL NUMBERS

1055-461-07-0000
1057-121-01-0000
1057-131-02-0000



THIS MAP CORRECTLY SHOWS THE LOT OR PARCEL OF LAND INCLUDED WITHIN THE BOUNDARIES OF THE COMMUNITY FACILITIES DISTRICT. FOR DETAILS CONCERNING THE LINES AND DIMENSIONS OF LOTS OR PARCELS REFER TO THE SAN BERNADINO COUNTY ASSESSOR'S MAPS FOR FISCAL YEAR 2025-2026.