

ANNEXATION MAP NO. 9
COMMUNITY FACILITIES DISTRICT NO. 2003-3
IMPROVEMENT AREA NO. 5
OF THE CITY OF CHINO,
COUNTY OF SAN BERNARDINO, STATE OF CALIFORNIA

THIS MAP SHOWS THE BOUNDARIES OF THE AREA PROPOSED TO BE ANNEXED INTO IMPROVEMENT AREA NO. 5 OF COMMUNITY FACILITIES DISTRICT NO. 2003-3 OF THE CITY OF CHINO, COUNTY OF SAN BERNARDINO, STATE OF CALIFORNIA, THE BOUNDARIES OF WHICH COMMUNITY FACILITIES DISTRICT ORIGINAL BOUNDARY MAP WAS RECORDED AS INSTRUMENT NO. 2003-083346 IN BOOK 76 OF MAPS OF ASSESSMENT AND COMMUNITY FACILITIES DISTRICTS AT PAGES 11-17. THE FIRST AMENDED BOUNDARY MAP WAS RECORDED AS INSTRUMENT NO. 2005-0195713 IN BOOK 78 OF MAPS OF ASSESSMENT AND COMMUNITY FACILITIES DISTRICTS AT PAGES 8-14, THE SECOND AMENDED BOUNDARY MAP WAS RECORDED AS INSTRUMENT NO. 2005-0719640 IN BOOK 78 OF MAPS OF ASSESSMENT AND COMMUNITY FACILITIES DISTRICTS AT PAGES 84-90, THE THIRD AMENDED BOUNDARY MAP WAS RECORDED AS INSTRUMENT NO. 2008-0142286 IN BOOK 83 OF MAPS OF ASSESSMENT AND COMMUNITY FACILITIES DISTRICTS AT PAGES 79-85, AND THE FOURTH AMENDED BOUNDARY MAP WAS RECORDED AS INSTRUMENT NO. 2013-0519677 IN BOOK 86 OF MAPS OF ASSESSMENT AND COMMUNITY FACILITIES DISTRICTS AT PAGES 1-7. ALL MAPS HAVE BEEN RECORDED IN THE OFFICE OF THE COUNTY RECORDER FOR THE COUNTY OF SAN BERNARDINO, STATE OF CALIFORNIA.

I HEREBY CERTIFY THAT THE WITHIN MAP SHOWING THE PROPOSED BOUNDARY OF ANNEXATION NO. 9 TO IMPROVEMENT AREA NO. 5 OF COMMUNITY FACILITIES DISTRICT NO. 2003-3, CITY OF CHINO, COUNTY OF SAN BERNARDINO, STATE OF CALIFORNIA, WAS APPROVED BY THE CITY COUNCIL OF SAID CITY OF CHINO AT A REGULAR MEETING THEREOF HELD ON THE ____ DAY OF _____, 2025, BY RESOLUTION NO. _____.

CITY CLERK, CITY OF CHINO

FILED IN THE OFFICE OF THE CITY CLERK OF CHINO
ON THIS ____ DAY OF _____, 2025

BY: _____
CITY CLERK, CITY OF CHINO

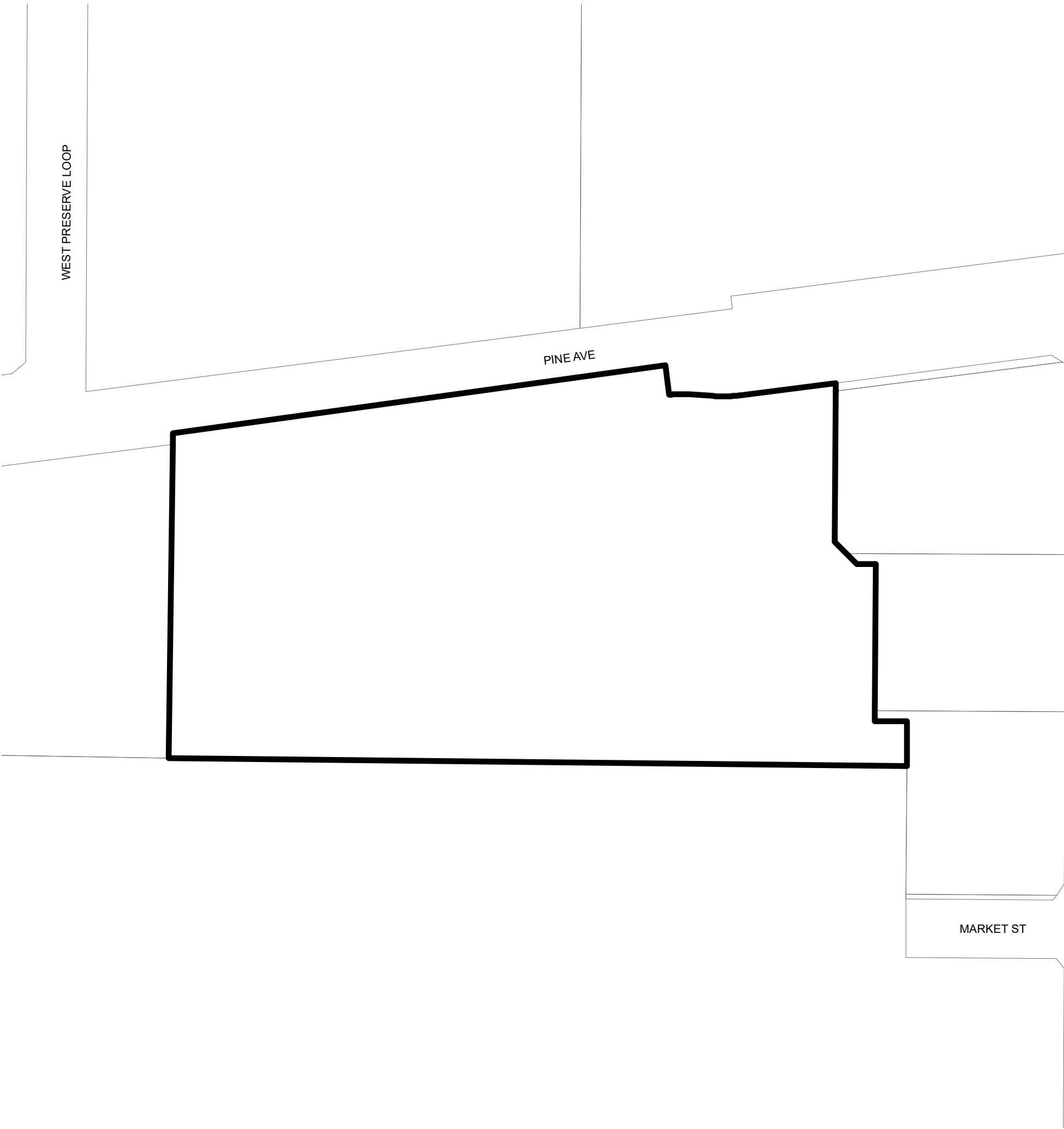
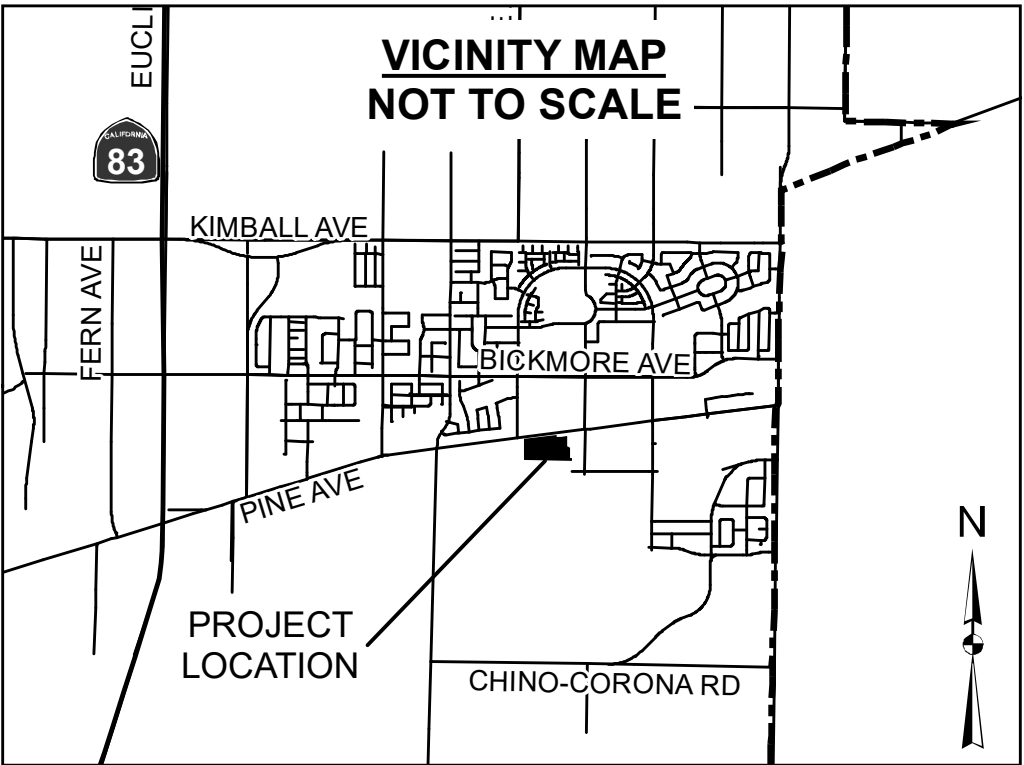

SAN BERNARDINO COUNTY RECORDER'S CERTIFICATE

THIS MAP HAS BEEN FILED UNDER DOCUMENT NUMBER _____ THIS ____ DAY OF _____ 2025 AT _____ M.

IN BOOK _____ OF _____
AT PAGE _____ AT THE REQUEST OF THE CITY
OF CHINO IN THE AMOUNT OF \$ _____

CHRIS WILHITE
ASSESSOR-RECORDER-COUNTY CLERK
SAN BERNARDINO COUNTY

BY: _____
DEPUTY RECORDER

ASSESSOR PARCEL NUMBERS
1057-441-04-0000

LEGEND

———— ANNEXATION BOUNDARY

———— PARCEL BOUNDARY

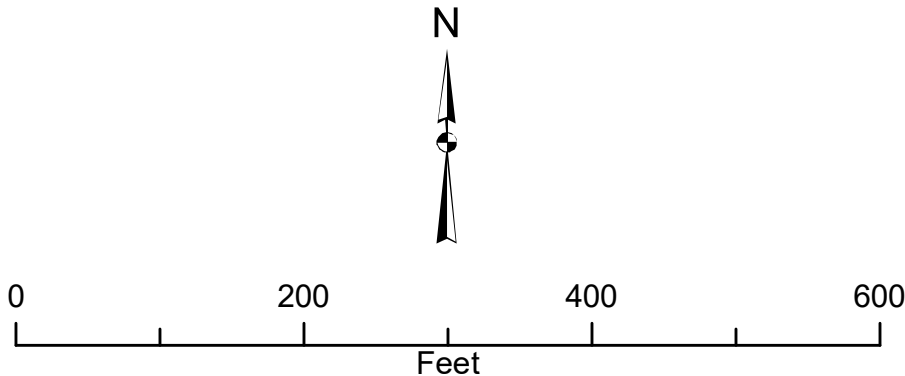

THIS ANNEXATION MAP CORRECTLY SHOWS THE LOT OR PARCEL OF LAND INCLUDED WITHIN THE BOUNDARIES OF THE COMMUNITY FACILITIES DISTRICT. FOR DETAILS CONCERNING THE LINES AND DIMENSIONS OF LOTS OR PARCELS REFER TO THE COUNTY ASSESSOR'S MAPS FOR FISCAL YEAR 2024-25.